



FOR SALE

186 KING ST, THORNDALE

\$97,000

\$3,750 Gross Rent

1,585 Sq Ft

Licensed Restaurant

THORNDALE FAMILY RESTAURANT

Thorndale Family Restaurant, a beloved establishment that has been serving the community since 1988. This charming property offers a spacious main area spanning 1,585 sqft, complemented by a 450 sqft office space. 5+5+5 year term at \$3,750 gross, including TMI.

The restaurant boasts a liquor license for 73. With 200-amp power supply, the establishment is well-equipped to handle the demands of a bustling eatery. Willing to onboard/train new owners and available for immediate possession.

Exploding population of the town and only 10 mins away from London (International Airport, Western University). With its rich history and versatile space, this property is primed to continue its legacy as a gathering place for locals and visitors alike.

READY FOR SECONDS?

Call me to discuss this listing today.



MANNA AU, Sales Representative
416-843-4318
manna@carverestate.com
carverestate.com

RYAN EARL, Broker and Founder
416-618-0054
ryan@carverestate.com
carverestate.com

Royal LePage Signature Realty
Ind. Owned & Operated Brokerage
8 Sampson Mews, Suite 201, Toronto, ON. M3C 0H5
This document is not meant to solicit existing listings. (12.2002)

carve REAL ESTATE



MANNA AU, Sales Representative
416-843-4318
manna@carverestate.com
carverestate.com

RYAN EARL, Broker and Founder
416-618-0054
ryan@carverestate.com
carverestate.com

Royal LePage Signature Realty
Ind. Owned & Operated Brokerage
8 Sampson Mews, Suite 201, Toronto, ON. M3C 0H5
This document is not meant to solicit existing listings. (12.2002)



OTHER LOCATIONS:



WICH IS WICH

- Food court QSR
- 600 sq ft
- \$1,850 gross rent
- Mall seating for 100



JAD SHAWARMA

- Authentic shawarma in London, Ontario
- 1,800 sq ft
- \$4,247 gross rent
- Seating for 24



BEACH BOY BURGER

- Popular with locals and tourists
- 800 sq ft
- \$3,330 gross rent
- Licensed for 20 + 30 on patio



MANNA AU, Sales Representative
416-843-4318
manna@carverestate.com
carverestate.com

RYAN EARL, Broker and Founder
416-618-0054
ryan@carverestate.com
carverestate.com

Royal LePage Signature Realty
Ind. Owned & Operated Brokerage
8 Sampson Mews, Suite 201, Toronto, ON. M3C 0H5
This document is not meant to solicit existing listings. (12.2002)

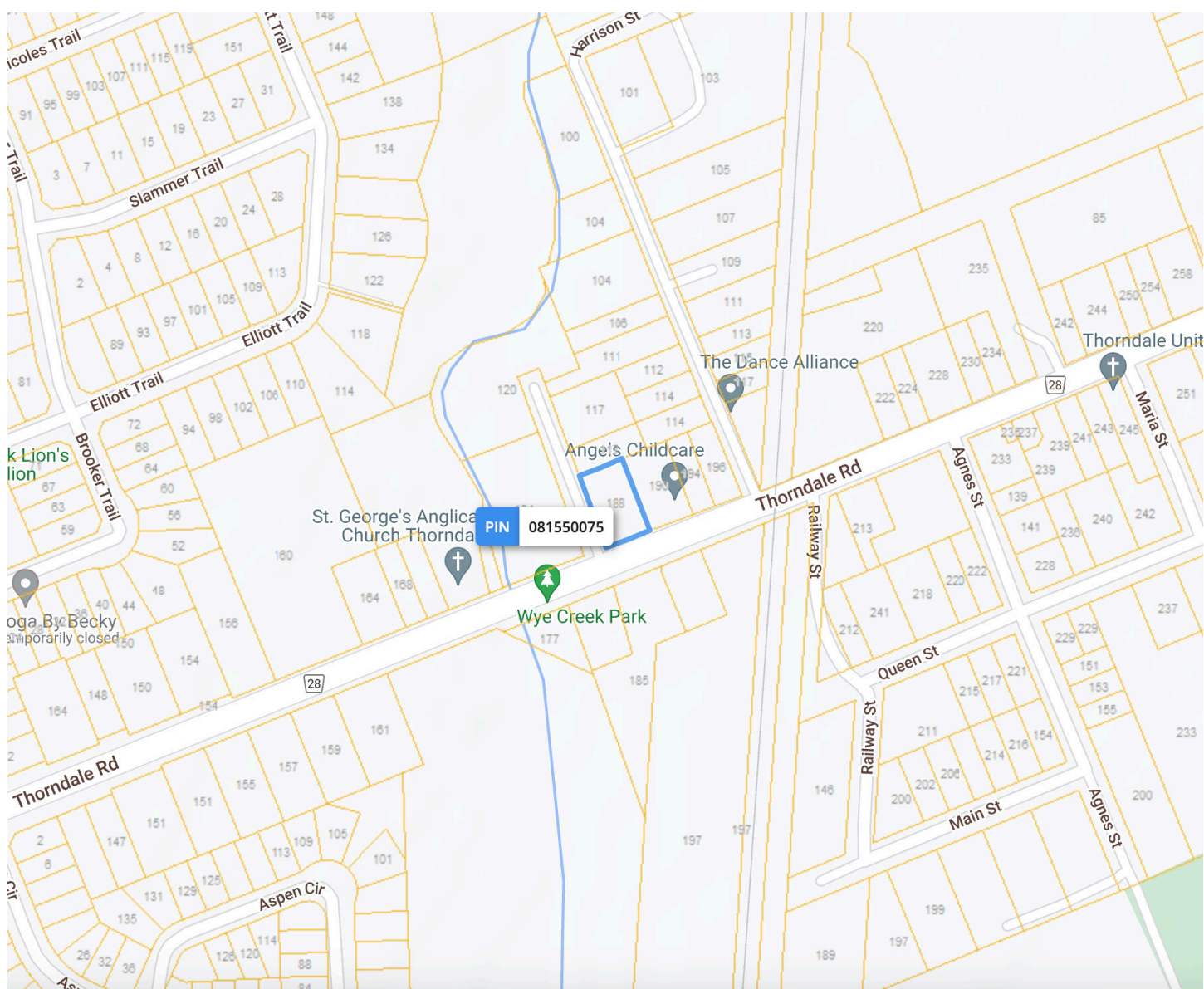

MANNA AU, Sales Representative
416-843-4318
manna@carverestate.com
carverestate.com

RYAN EARL, Broker and Founder
416-618-0054
ryan@carverestate.com
carverestate.com

Royal LePage Signature Realty
Ind. Owned & Operated Brokerage
8 Sampson Mews, Suite 201, Toronto, ON. M3C 0H5
This document is not meant to solicit existing listings. (12.2002)

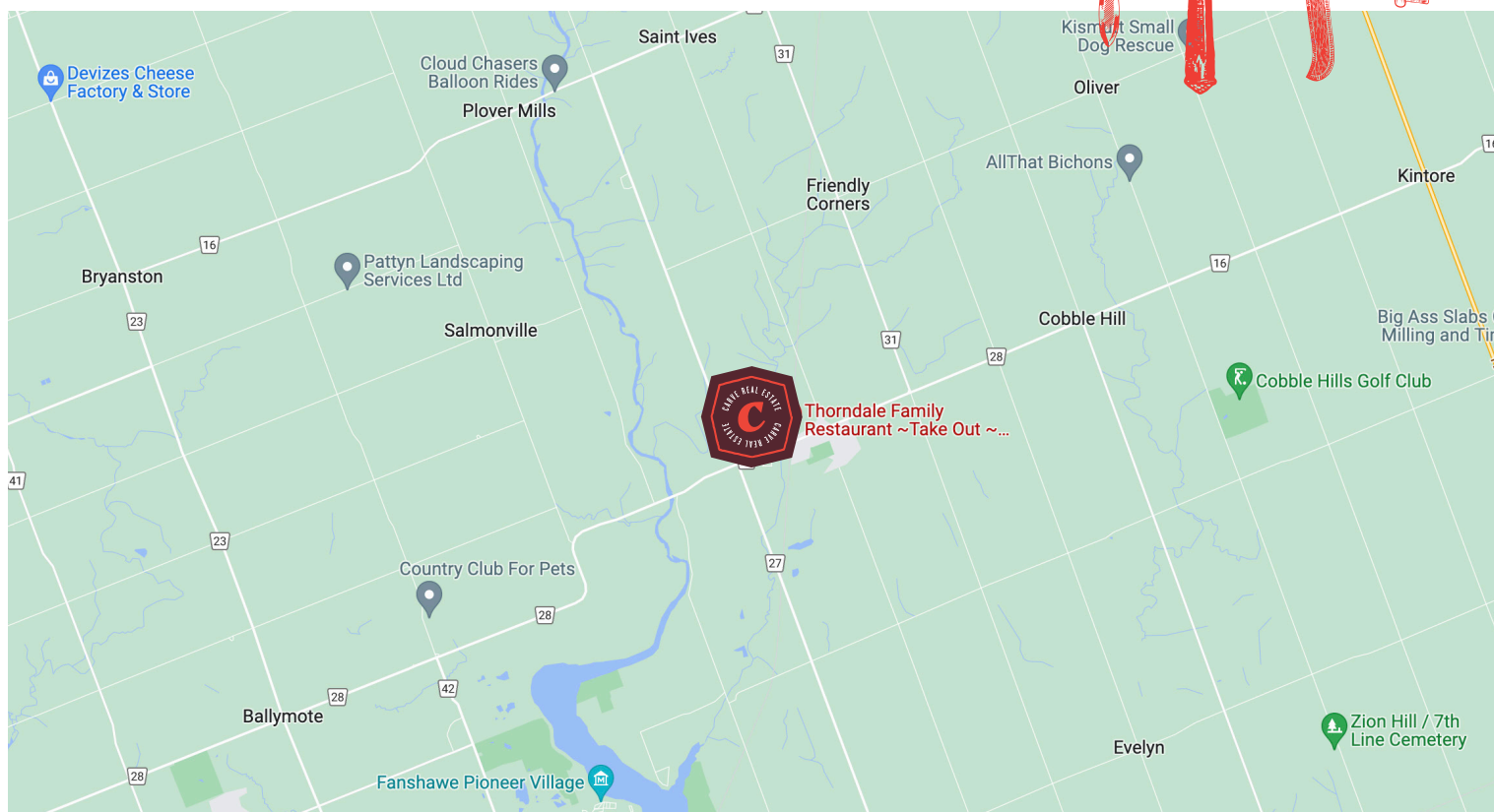

BUILDING DETAILS

This listing presents a fantastic opportunity with a spacious main area of 1,585 square feet, accompanied by a 450 square foot office space. New AC Unit installed autumn 2021. All chattels and equipment owned outright and included.

The restaurant boasts a liquor license for 73, inviting guests to savor delightful dining experiences.

Property Details: With a new term offering a fresh start, the property features a 200-amp power supply making it well-equipped to cater to the demands of a bustling restaurant.

Owners agreed to pay the maintenance/repair of the roof but will not be responsible for other day to day maintenance.

LOT SIZE

Frontage:
100.37 ft along King St

Depth:
Approximately 166.1 ft

Dimensions:
100.50 ft x 163.34 ft x 100.45 ft
x 166.17 ft

Size:
16,544.11 sqft



MANNA AU, Sales Representative
416-843-4318
manna@carverestate.com
carverestate.com

RYAN EARL, Broker and Founder
416-618-0054
ryan@carverestate.com
carverestate.com

Royal LePage Signature Realty
Ind. Owned & Operated Brokerage
8 Sampson Mews, Suite 201, Toronto, ON. M3C 0H5
This document is not meant to solicit existing listings. (12.2002)